

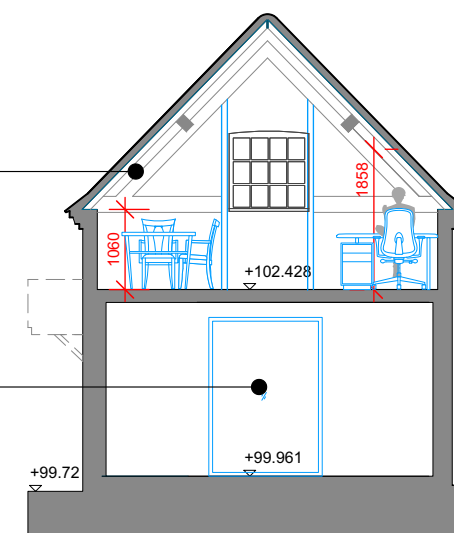

1 PROPOSED SECTION AA  
Scale: 1:100

- KEY**
- Existing walls
  - Existing fittings
  - 00.00 Existing level
  - New walls
  - New fittings
  - 00.00 New level



Timber roof structure adapted to create open plan office space

New timber-framed window to street-facing facade

2 PROPOSED SECTION BB  
Scale: 1:100

THIS DRAWING IS BASED ON DIMENSIONAL SURVEY INFORMATION PROVIDED BY OTHERS. THE ARCHITECT CANNOT ACCEPT RESPONSIBILITY FOR THE ACCURACY OF THIS SURVEY INFORMATION. THIS DRAWING SHOULD BE READ IN CONJUNCTION WITH ALL RELEVANT DRAWINGS, SPECIFICATIONS, SCHEDULES AND OTHER CONTRACT INFORMATION ISSUED BY THE ARCHITECT, STRUCTURAL ENGINEER, SERVICES ENGINEER AND ANY OTHER CONSULTANT EMPLOYED OR RETAINED BY THE EMPLOYER IN RESPECT OF THESE WORKS. REPORT ANY DISCREPANCIES, CONFLICTS, ERRORS OR OMISSIONS TO THE CA AND SEEK DIRECTIONS BEFORE PROCEEDING. ONLY DRAWINGS SHOWN WITH STATUS 'CONSTRUCTION' ARE TO BE USED FOR CONSTRUCTION. IN THE CASE OF NEW WORKS, ALL DIMENSIONS SHOWN ARE TO THE FACE OF MASONRY, THE CENTRE LINE OF STRUCTURAL STEEL MEMBERS, OR THE FINISHED FACE OF STUD PARTITIONS, UNLESS NOTED OTHERWISE. CONFIRM ALL DIMENSIONS AND LEVELS ON SITE PRIOR TO COMMENCING WORK. IF IN DOUBT ASK! DO NOT SCALE FROM THIS DRAWING; USE ONLY FIGURED DIMENSIONS. THIS DRAWING REMAINS THE COPYRIGHT OF BURRELL FOLEY FISHER LLP

- Notes**
- All M&E items to be stripped out (sockets, light fittings, radiators)
  - All existing RWP's to be retained, repaired or replaced where necessary.
  - All new openings will require new lintels as per Structural Engineer Information.
  - The contractor is responsible for protection of all historic fabric.

To be read in conjunction with Structural Engineer Information and drawings.  
Drawing to be printed in color.

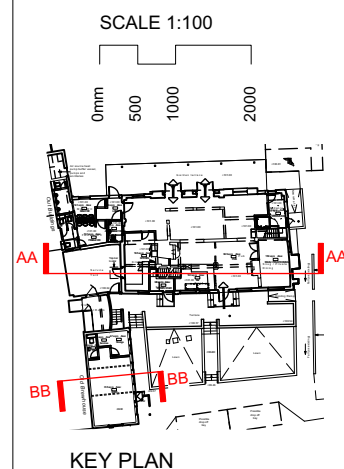

P3	ISSUED FOR PLANNING & LISTED BUILDING CONSENT	SH/RS	23.10.23
P2	DRAFT - FOR COMMENTS	SH/RS	13.10.23
P1	STAGE 2 ISSUE	AD/AR	25.05.23
REV.	NOTES:	BY/CHKD:	DATE:

PLANNING & LBC  
DO NOT SCALE OFF THIS DRAWING  
**BURRELL FOLEY FISHER**  
ARCHITECTS AND URBAN DESIGNERS

STUDIO 9 14 SOUTHGATE ROAD LONDON N1 3LY  
TEL: 020 7620 6114  
www.bff-architects.co.uk mail@bff-architects.co.uk

JOB  
**THE WHITE LION**  
FOR:  
WHITE LION WORKING GROUP

AT:  
PAILTON

DRAWING TITLE:  
PROPOSED SECTION AA & BB

DATE: 01.05.2021	SCALE: 1:100@A3
JOB NO: BFF/1595	DRAWN BY: SH
	CHECKED BY: AR
DWG NO. (JOB-ORIG.-BLDG-LVL.-TYPE-ROLE-SHEET NO.-OP.-REV.) 1595-BFF-MB-XX-DR-A-0550 -P3	